

4100



mounting

ceiling & wall

*) bending

Minimum radius 15 cm. Larger radius (20, 25, 30 cm) strongly recommended for smoother curtain movement in bends.

profile

4100 Shower rail
405 gr/m

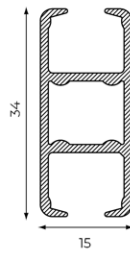

bending

radius cm
R 15* (1015)
R 20 (1015)
R 30 (1015)
R >80 (1018)

filler position

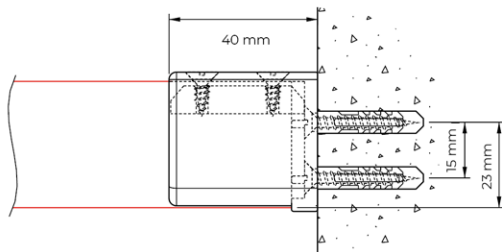
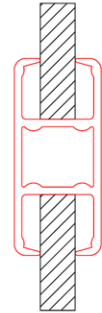

wall mounting 4100 with wall bracket 4149

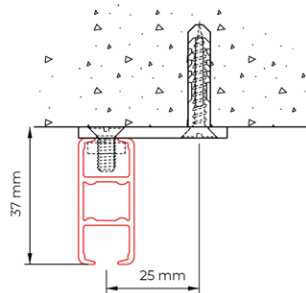

ceiling mounting 4100 with ceiling bracket 4135

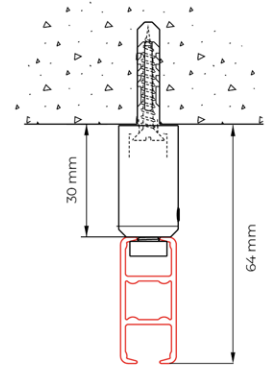

ceiling mounting 4100 with

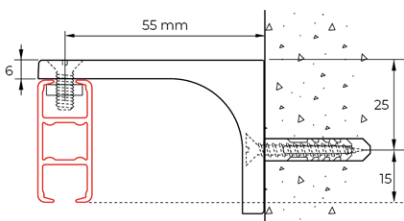

wall mounting 4100 with wall bracket 4140

Suspension hangers

ceiling mounting 4100:
threaded rod set 4055-10, suspension hanger tube 4055-40 and with mounting set 4055-30.

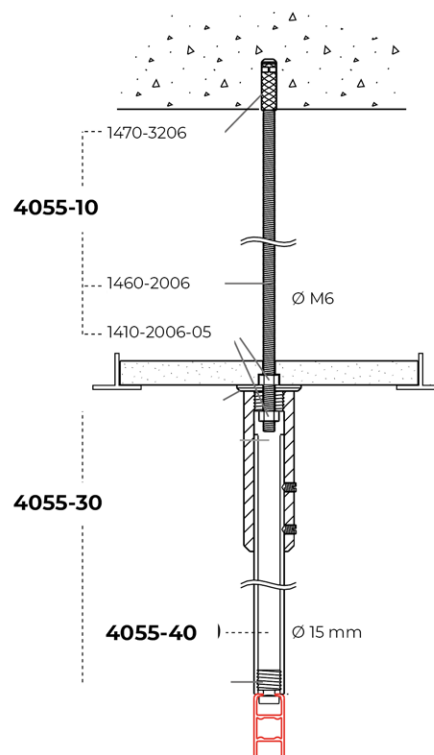

Application examples

standard shower rail situations and suspension hanger

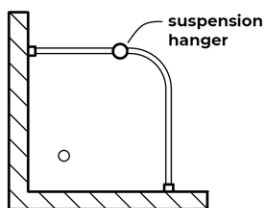

L-shaped (shower)

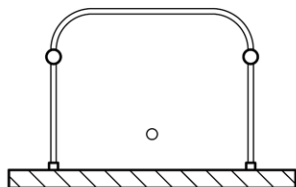

U-shaped (shower)

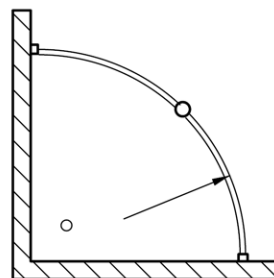

special (for example corner baths)

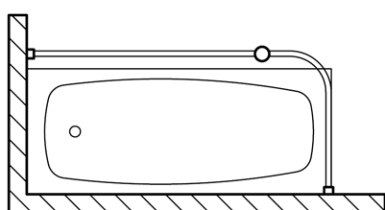

L-shaped (bath)

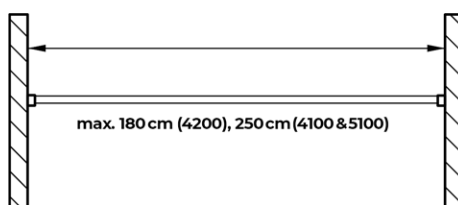

straight rail

max. 180 cm (4200), 250 cm (4100 & 5100)

perpendicular connections in 4100

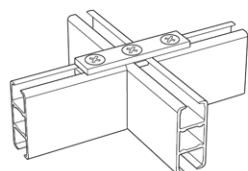

connection bracket 4130

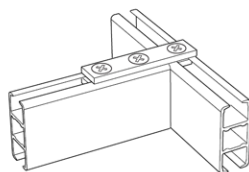

connection bracket 4130
for T junction

G-Norm

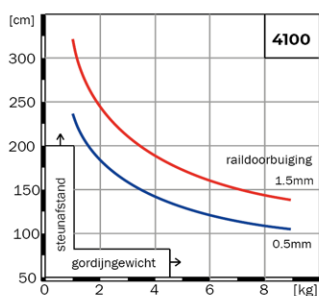

IEC 60364

IEC 60364 is a standard for o.a. isolated rail mounting. For further information please contact Qurails in Ede, The Netherlands